



Katana
2023 Assembly Guide



Katana
2023 Assembly Guide



TABLE OF CONTENTS

1. Frameset Parts.....	4
2. Parts included in the BOX.....	5
3. Cables Map - Rear Brake.....	6
4. Cables Map - Mechanical.....	7
5. Cables Map - Electronic.....	8
6. Di2 Battery Installation.....	9
7. Headset Installation.....	10
8. Expander Installation.....	11
9. Seatpost Installation.....	12

Katana

2023 Assembly Guide



1. Frameset Parts

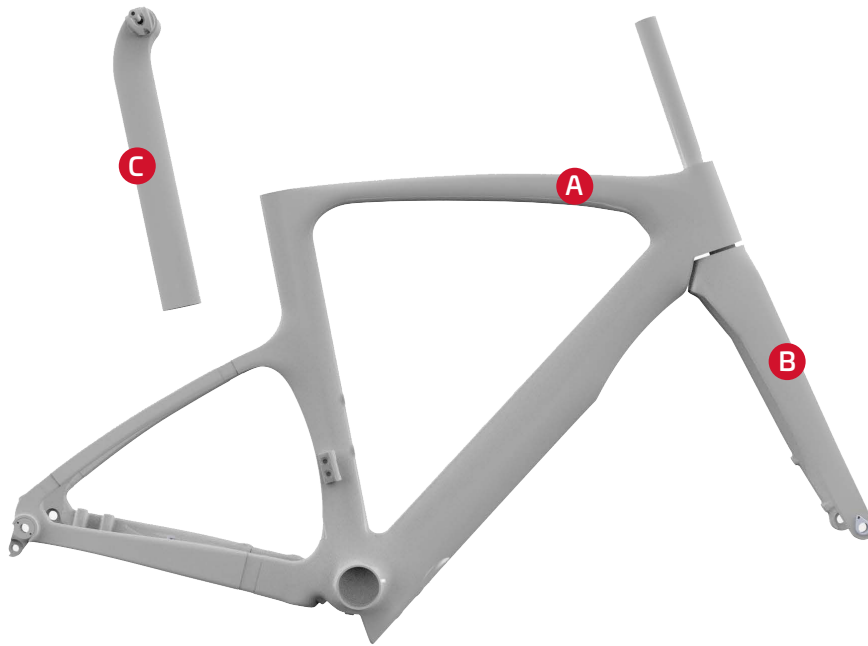

A Frame

B Fork

C Reversible Seatpost



2. Parts included in the BOX

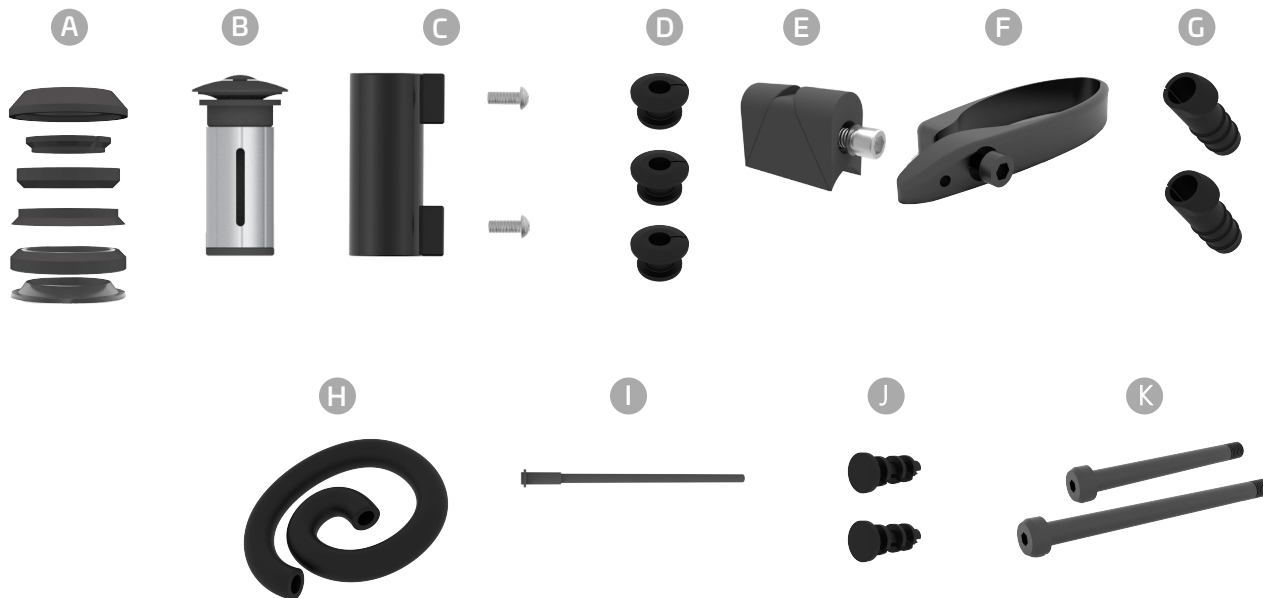

- A Headset
- B Expander
- C Di2 battery adaptor
- D Grommets for Di2 cable
- E Seat Clamp
- F Mini clamp
- G Grommets for mechanical cable
- H Foam tube
- I Alloy Pipes
- J Grommets for exit hole when using Sram AXS
- K Thru Axle



3. Cables Map - Rear Brake

A Rear Brake Cable

Cable entry (1) is located on top tube near the head tube. Thread the cable casing into the first center hole until you can grab it at the bottom down tube exit (2), then guide it toward brake caliper.



No special parts or tools needed.

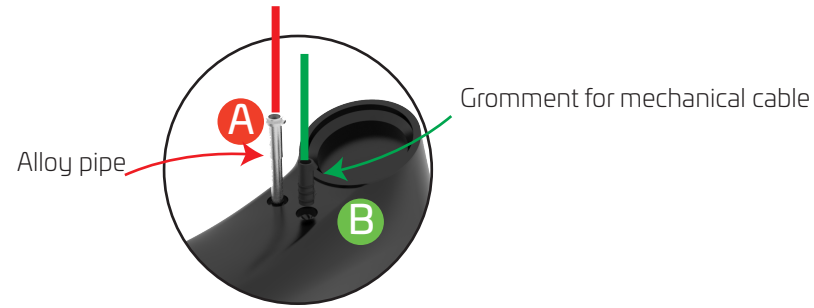

4. Cables Map - Shiftings (mechanical)

A Map Front Derailleur (mechanical)

Cable entry (1) is located on top tube near the head tube. Thread the cable casing until you can grab it at the bottom down tube exit (2), then guide it toward front derailleur exit hole (3).

B Map Rear Derailleur (mechanical)

Cable entry (1) is located on top tube near the head tube. Thread the cable casing until you can grab it at the bottom down tube exit (2), then guide it toward rear derailleur exit hole (4).

the rear derailleur cable is complete cable housing.







5. Cables Map - Shiftings (electronic)

A Map Front Derailleur (electronic)

From the battery junction box, guide it toward front derailleur exit hole (1).

B Map Rear Derailleur (electronic)

From the battery junction box, guide it toward rear derailleur exit hole (2).

-  connect to battery
-  the wire connect to shift
-  the wire connect to front derailleur
-  the wire connect to rear derailleur

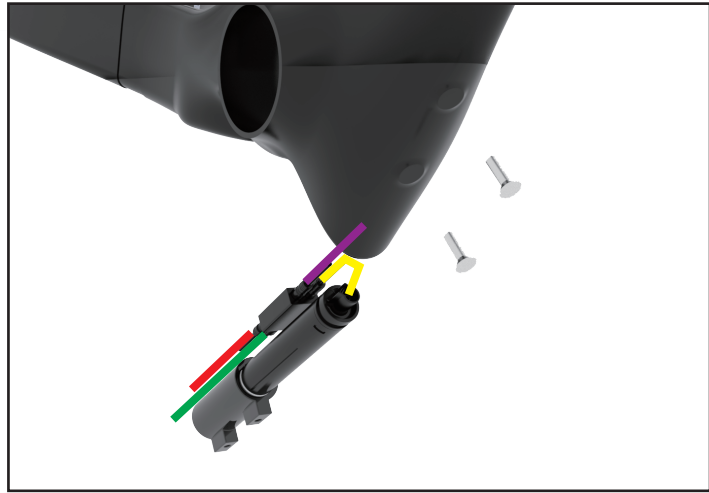



6. Di2 Battery Installation





Step 1

Secure battery in the provided battery holder.

Step 2

Hold the battery in place by hand while screws are put in place to hold battery assembly inside.

 We suggest to tape or tie wrap excess cable and Shimano junction to the battery before installation.

-  Di2 Battery Holder
-  Di2 Battery Collar
-  Adaptor Bolts
-  Washer
-  Internal Circlip

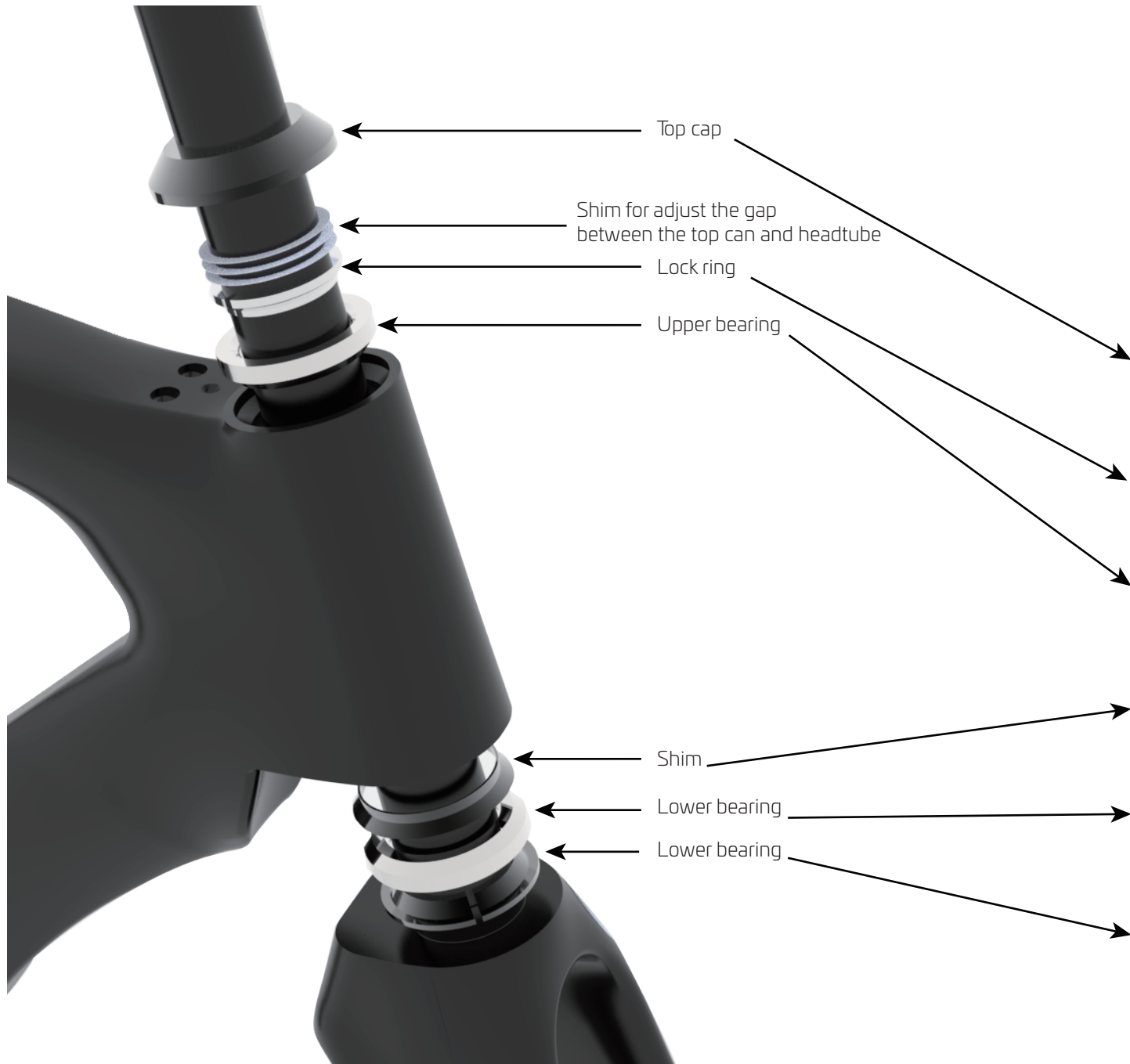

8. Headset Installation

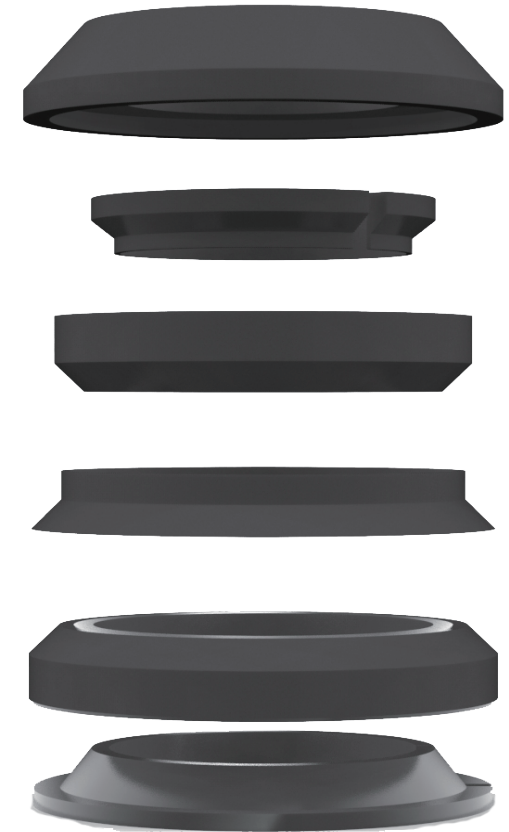



9. Expander Installation

The top cap mount after the setm.

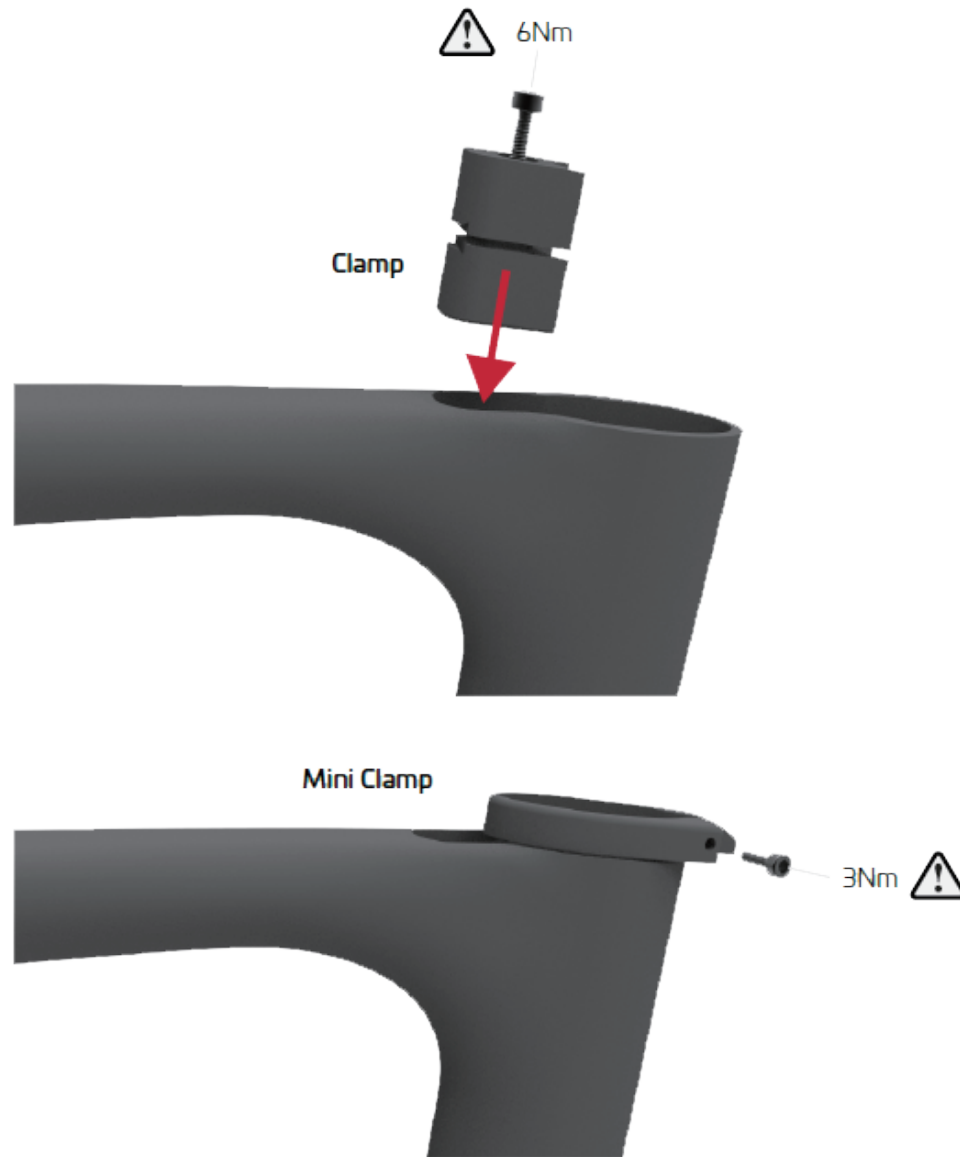

10. Seatpost Installation

Ceepeo reversible seat post is secured via 2 clamps.

Clamp

Wedge type must be placed inside clamp pocket inside frame, paying attention to have access to Allen key bolt head so you can tighten it.

Mini Clamp

Our Mini-clamp is to be placed on seat post prior to Installation.

 The mini clamp remains on seat post when removing it for travel.