



Mamba-R

2024 Assembly Guide



Mamba-R

2024 Assembly Guide



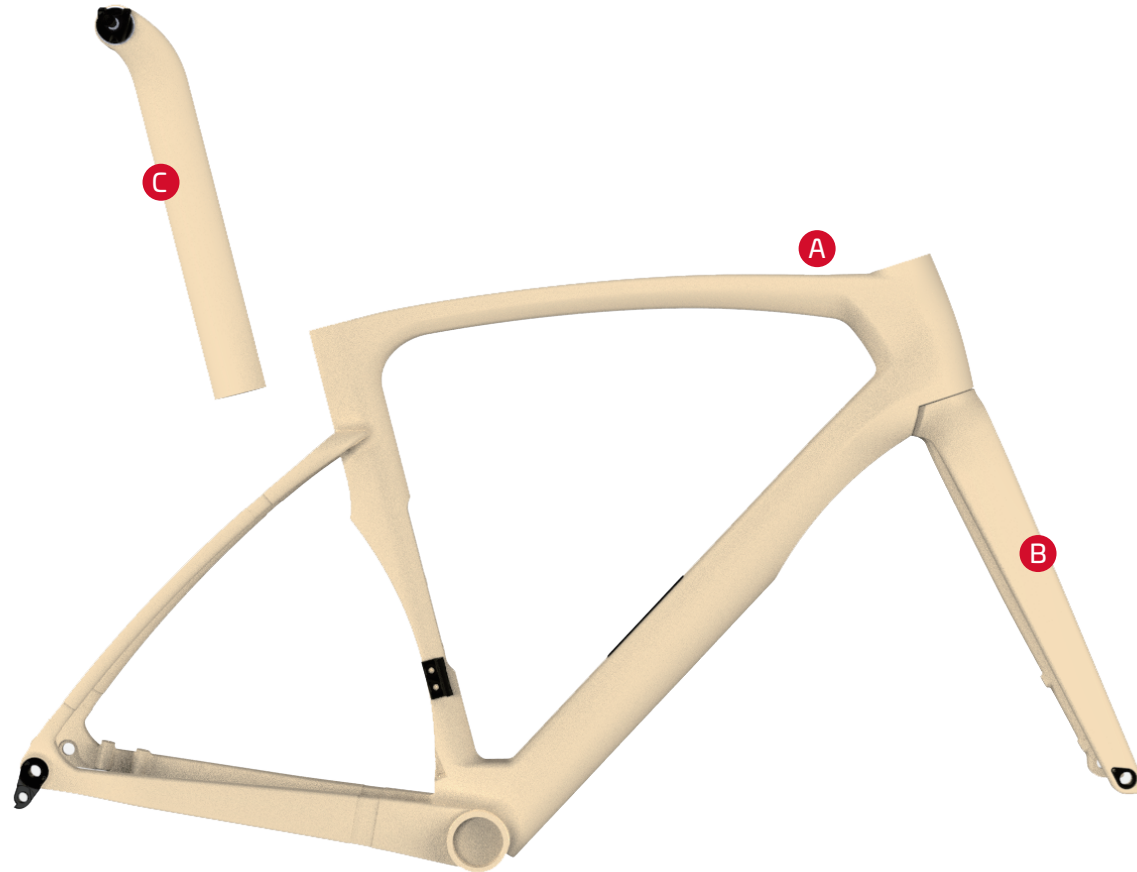

TABLE OF CONTENTS

1. Frameset Parts.....	4
2. Parts Included In the Box.....	5
3. A concept for assemble the cable integration bike.....	6
4. Headset Assemble.....	7
5. FSA SMR System (suite).....	8
6 Cables Map - Brake.....	9
7. Cables Map - Shiftings (electronic).....	10
8. Cables Map - Shiftings (mechanical).....	11
9. Cable Installation wirh Stem.....	12
10. Expander Plug.....	13
11. Seat Clamp & Mini Clamp.....	14

Mamba-R

2019 Assembly Guide



1. Frameset Parts

- A** frame
- B** Fork
- C** Reversible Seatpost



2. Parts Included In the Box



- A Headset
- B Expander
- C Di2 battery adaptor
- D Seat Clamp
- E mini Clamp
- F Rear thru axle
- G Front thru axle
- H Grommet for Shimano Di2 wire
- I Grommet for SRAM eTap (empty hole)
- J Grommet for rear brake exit hole
- K foam tube for rear brake housing
- L Grommet for mechanical shift cable
- M FSA SMR Stem

Mamba-R

2024 Assembly Guide



3. A concept for assemble the cable integration bike



Concept 1

Based on the parameters of the bike fitting, retain the necessary stem spacer and pre-cut the length of the fork steerer.

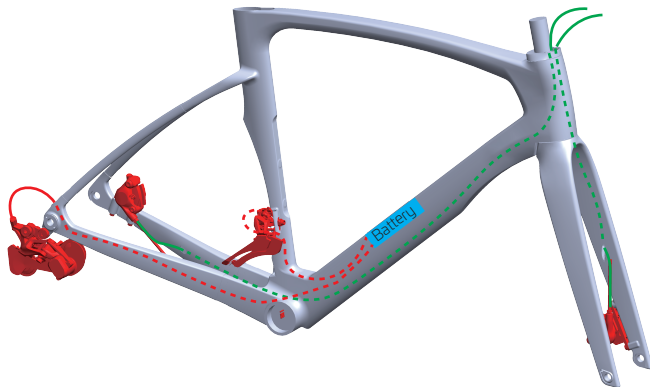

Concept 2

First, install the brakes and the front derailleur, the battery and rear derailleur, then leave the excess cables at the exit of the head tube.

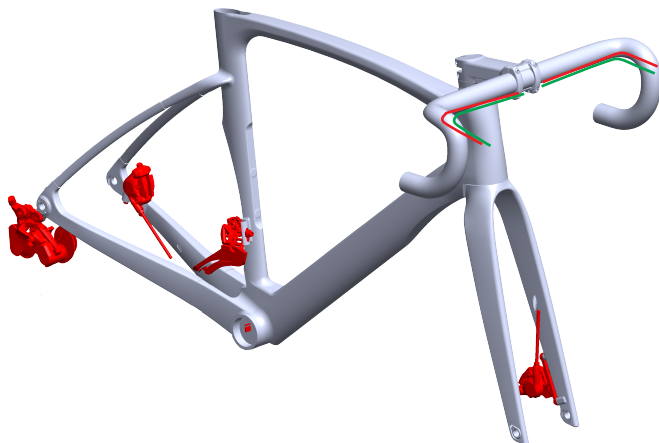

Concept 3

Finally, route the necessary cables through the stem to connect to the shift lever.



4. Headset Assemble

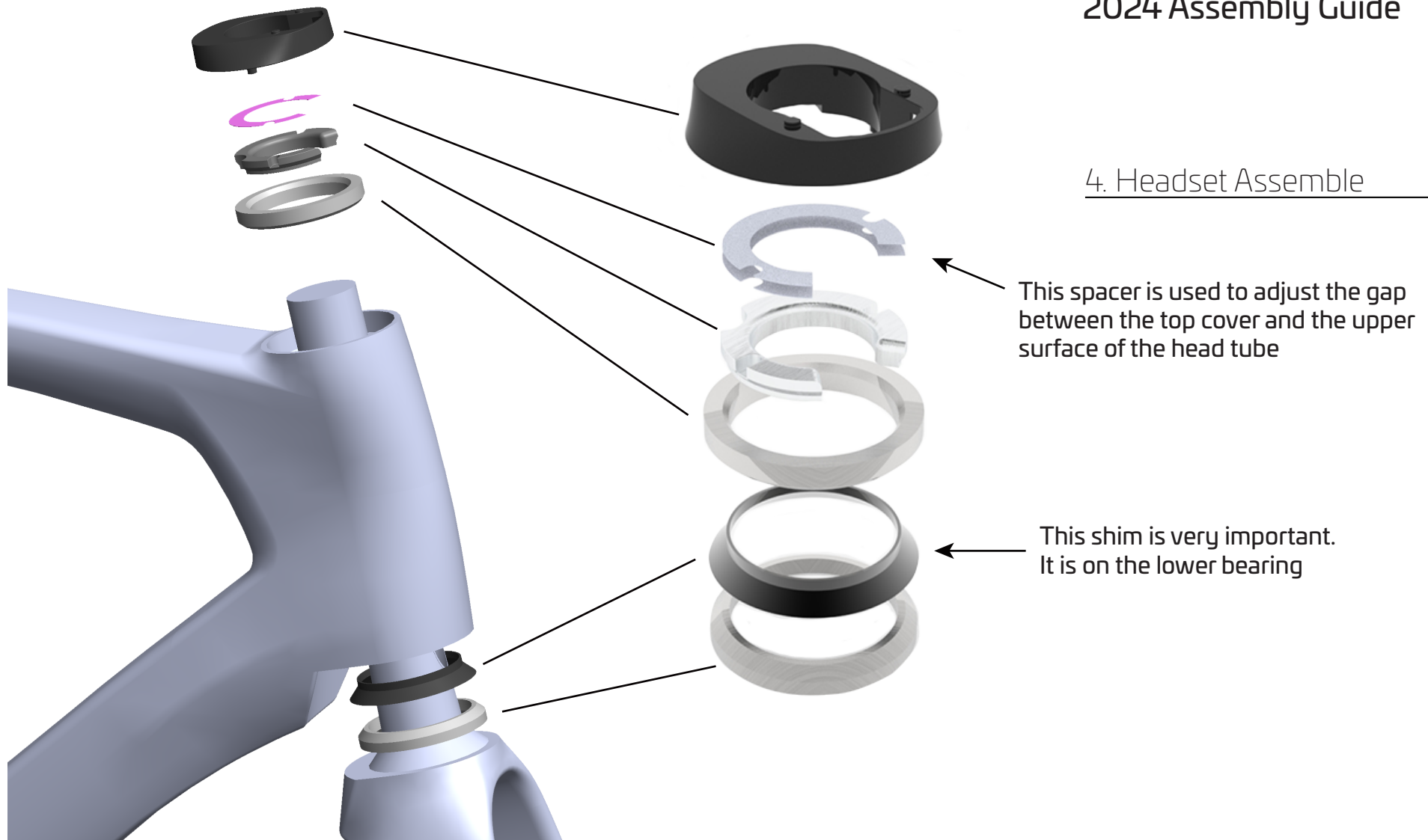

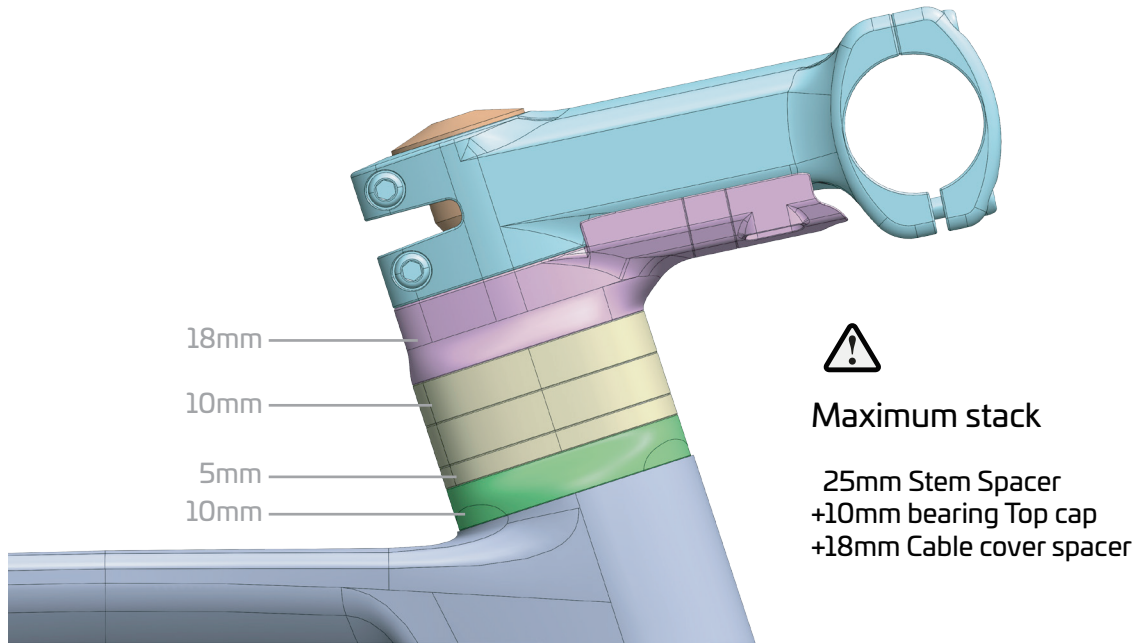

5. FSA SMR System (suite)



Mamba-R

2024 Assembly Guide

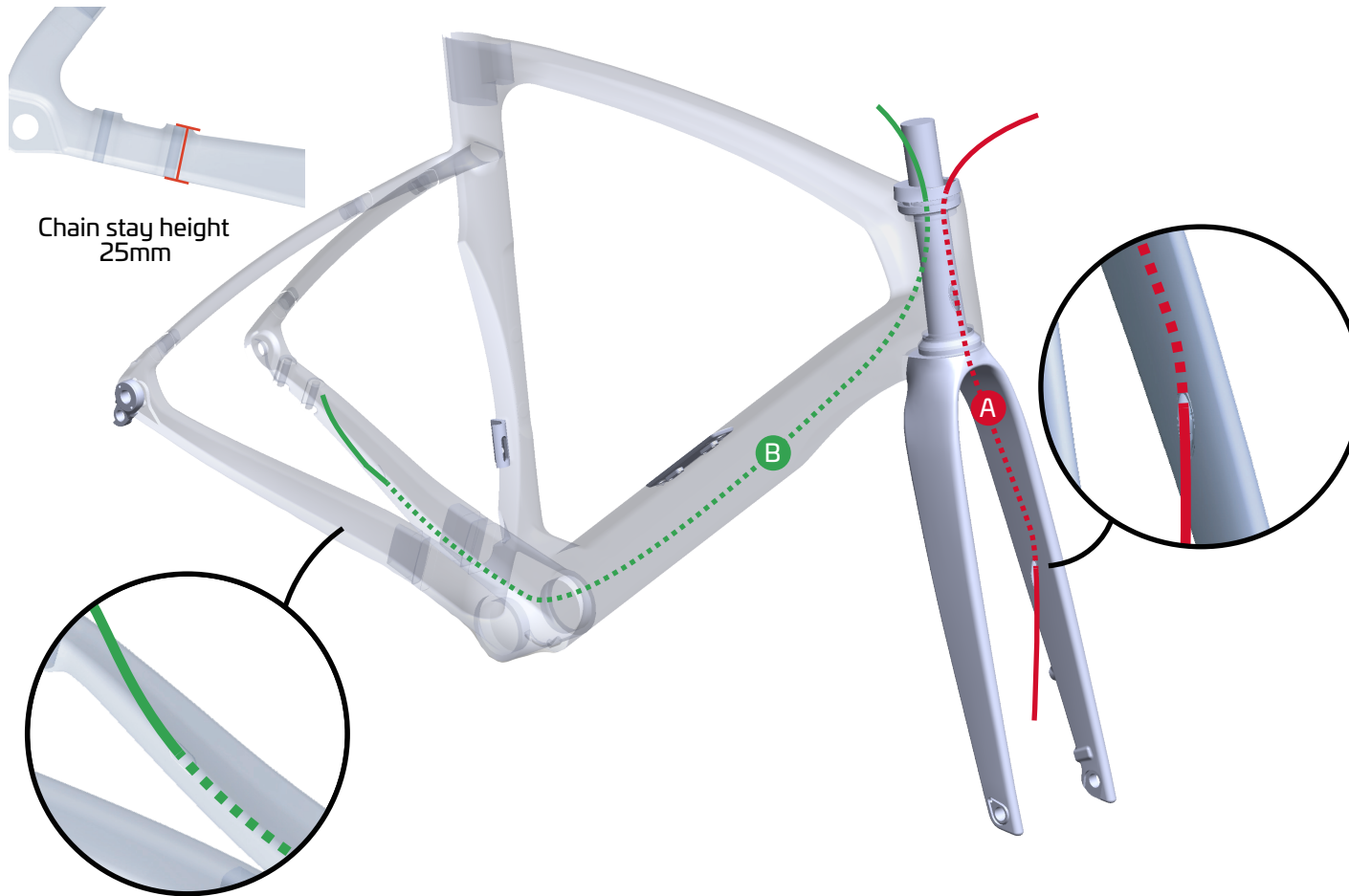

6 Cables Map - Brake

A Front Brake Hose

A single brake hose can pass through the fork steerer, so it doesn't require a connector bushing.

B Rear Brake Hose

If the rear brake is on the right hand, route the hose around the drive side of the fork inside the headtube.



These routing illustrations are intended as installation instructions only. For both hydraulic and mechanical disc brakes, please refer to that component's website to find further information.

Mamba-R

2024 Assembly Guide

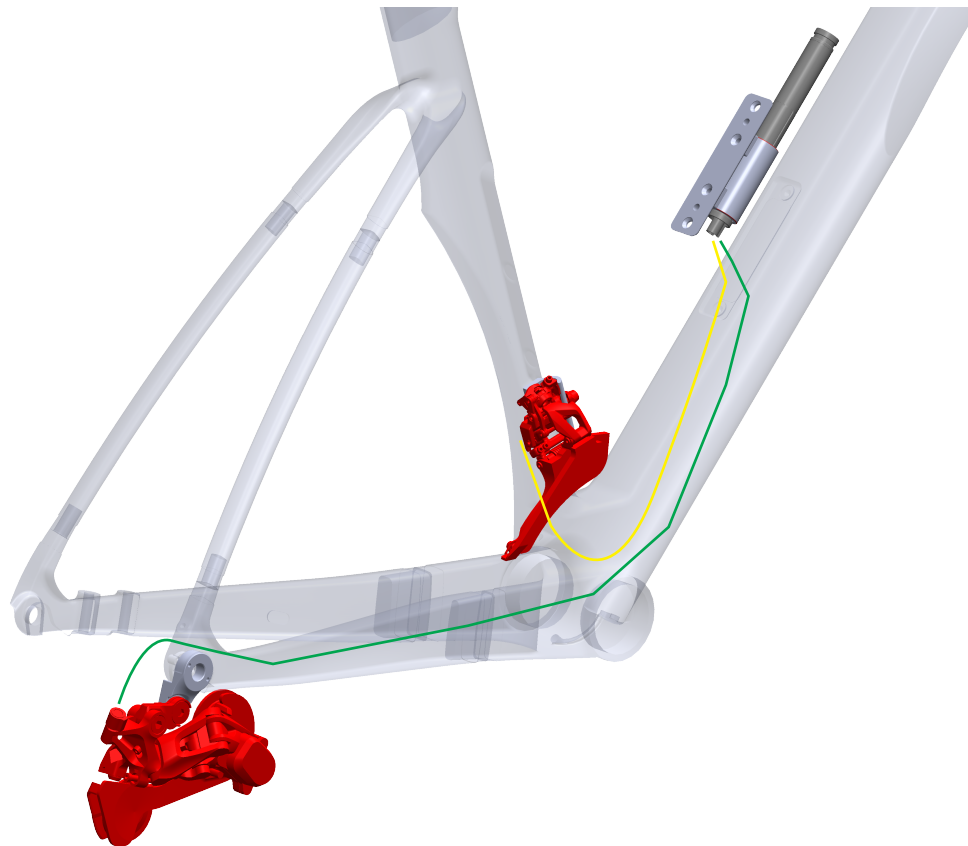

— the wire connect to front derailleur
— the wire connect to rear derailleur

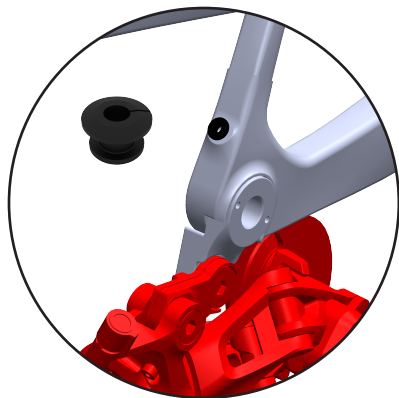

7. Cables Map - Shiftings (electronic)

A Map Front Derailleur (electronic)

From the battery, guide it toward front derailleur exit hole (1).

B Map Rear Derailleur (electronic)

From the battery, guide it toward rear derailleur exit hole (2).



8. Cables Map - Shiftings (mechanical)

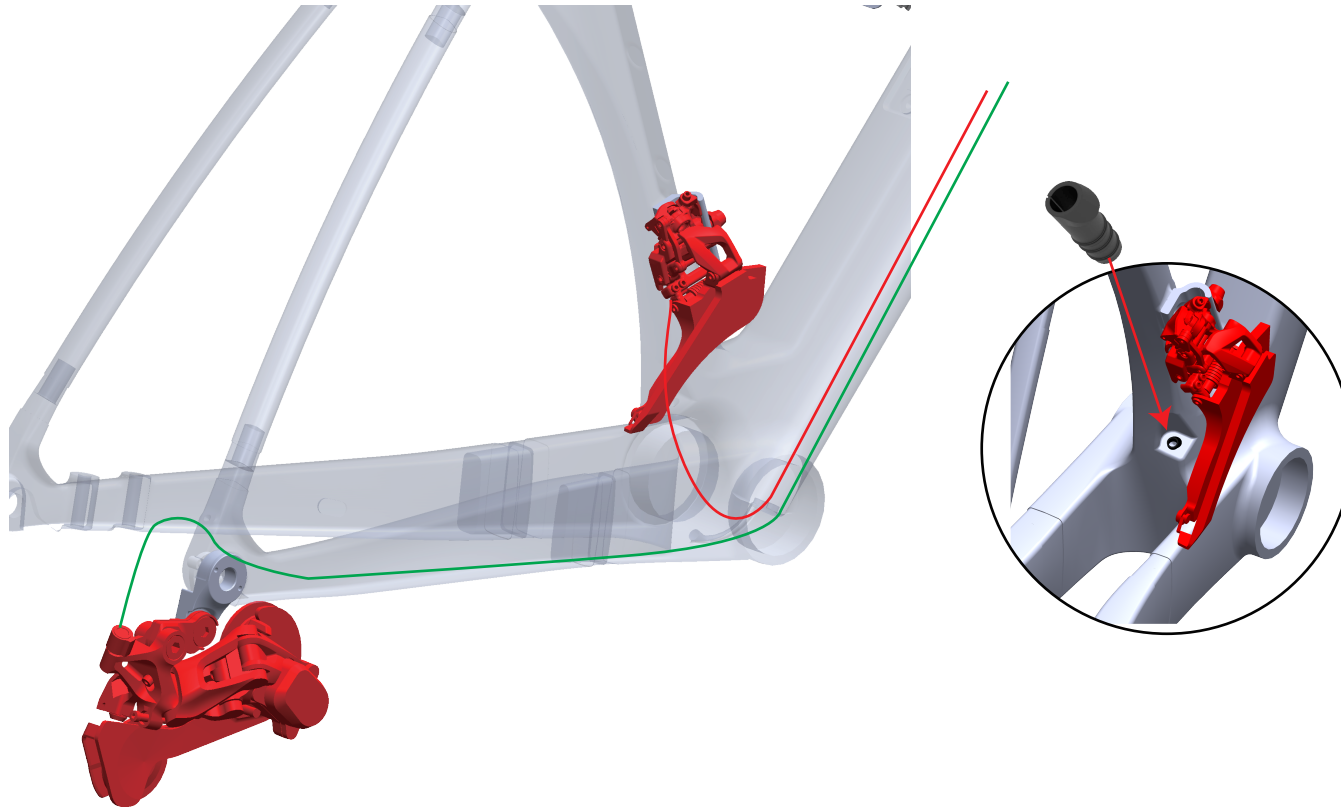

— the wire connect to front derailleur
— the wire connect to rear derailleur

A Map Front Derailleur (mechanical)

From the battery junction box, guide it toward front derailleur exit hole (1).

B Map Rear Derailleur (mechanical)

From the battery junction box, guide it toward rear derailleur exit hole (2).

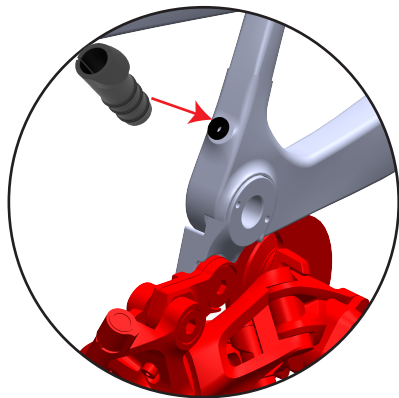

9. Cable Installation with Stem

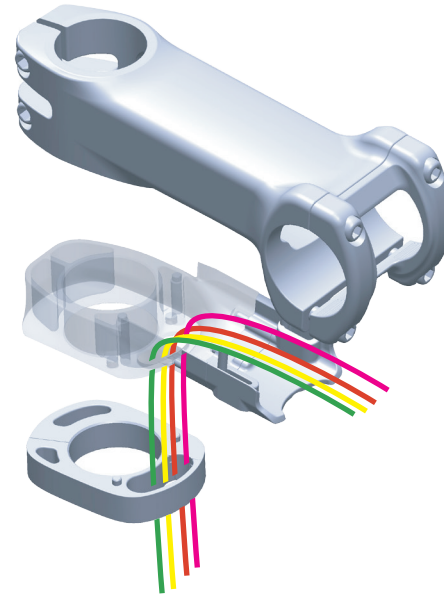
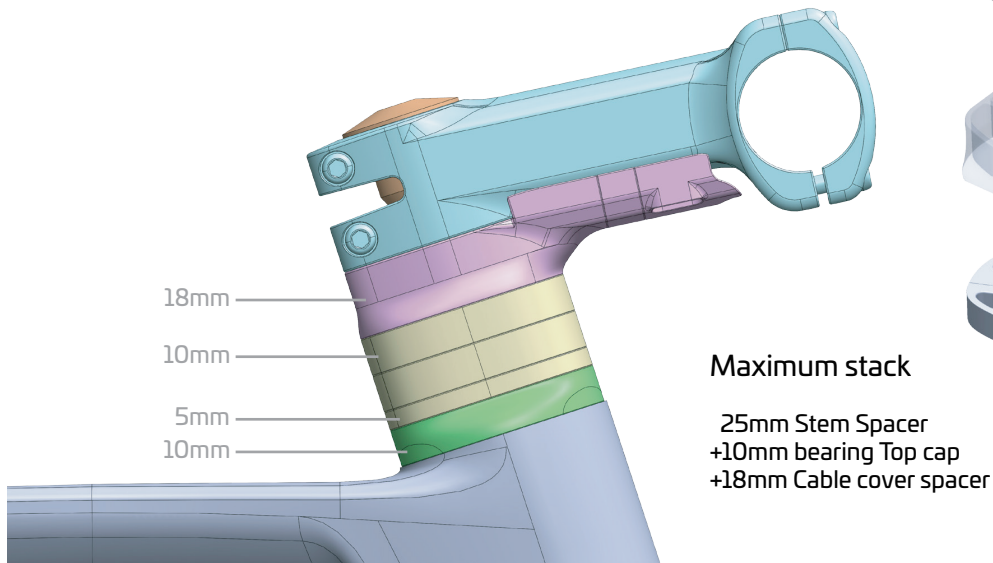

Situation 1:

if for Mechanical type, all cables connect to shift lever

Situation 2:

if for electronic type, brake cables connect to shift lever

- Front Brake Hose
- Rear Brake Hose
- Front Shift cable Hose
- Rear Shift cable Hose



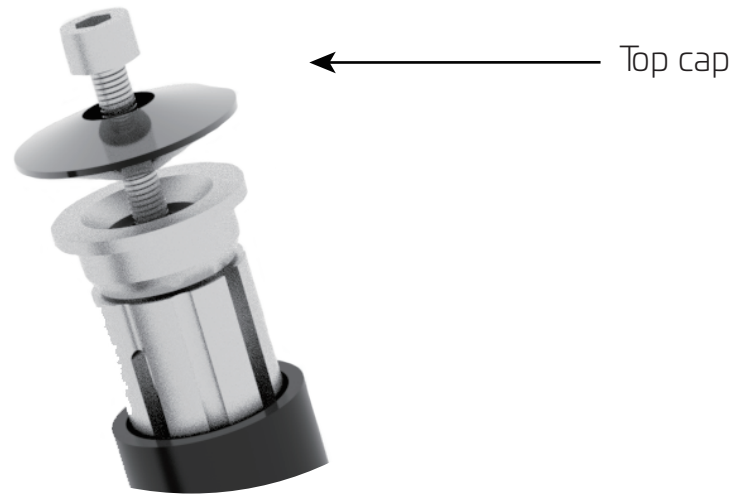

10. Expander Plug

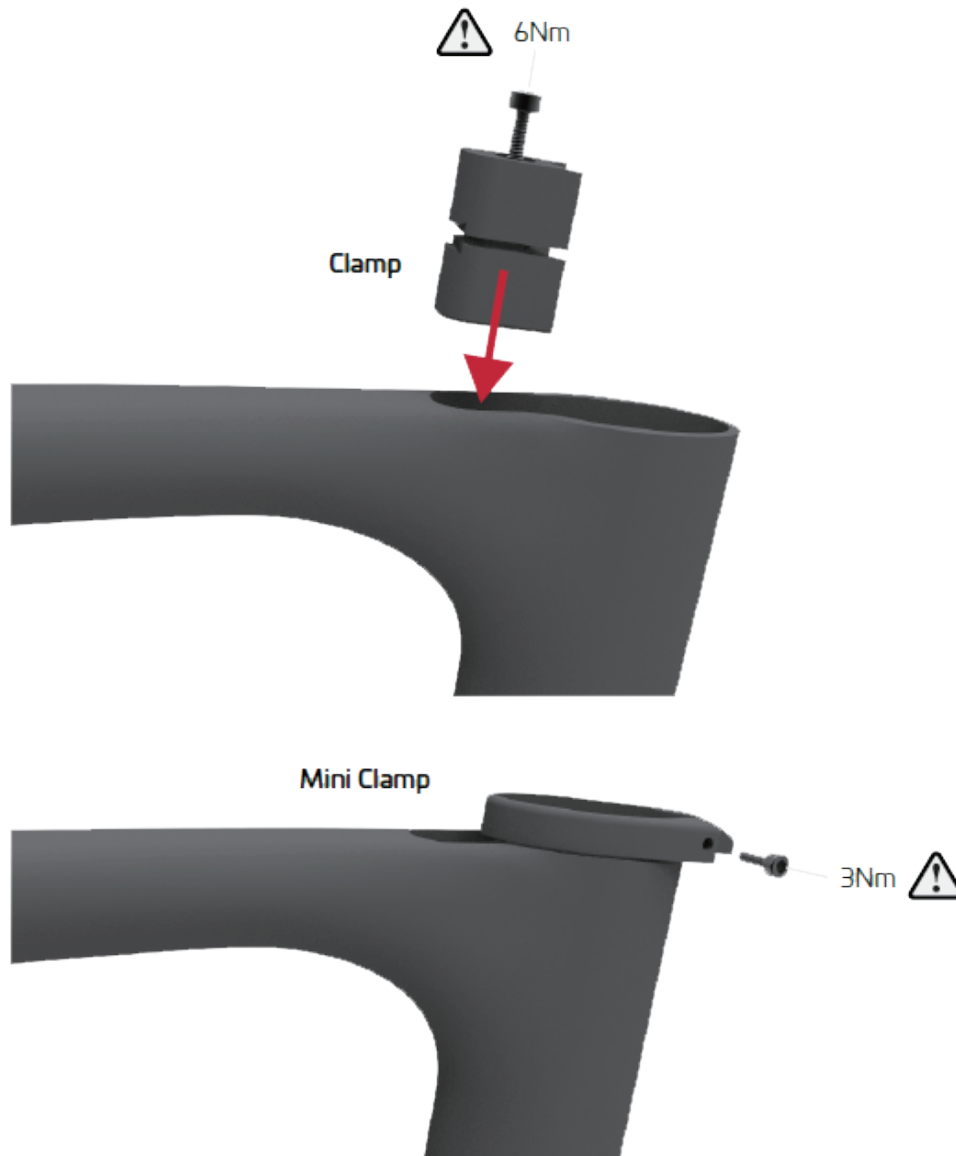

11. Seat Clamp & Mini Clamp